



Office of the  
Economic Community and Development  
Building Division

# Minimum Standards for WINDOW FLASHING

## I. Required Flashing

Exterior openings exposed to the weather shall be flashed in such a manner as to make them waterproof.

## II. Acceptable Methods

The following methods will be considered an acceptable method for the flashing of metal or wood frames. It may be used for all openings in wood frame exterior wall construction when the exterior wall finish is applied over building paper or felt.

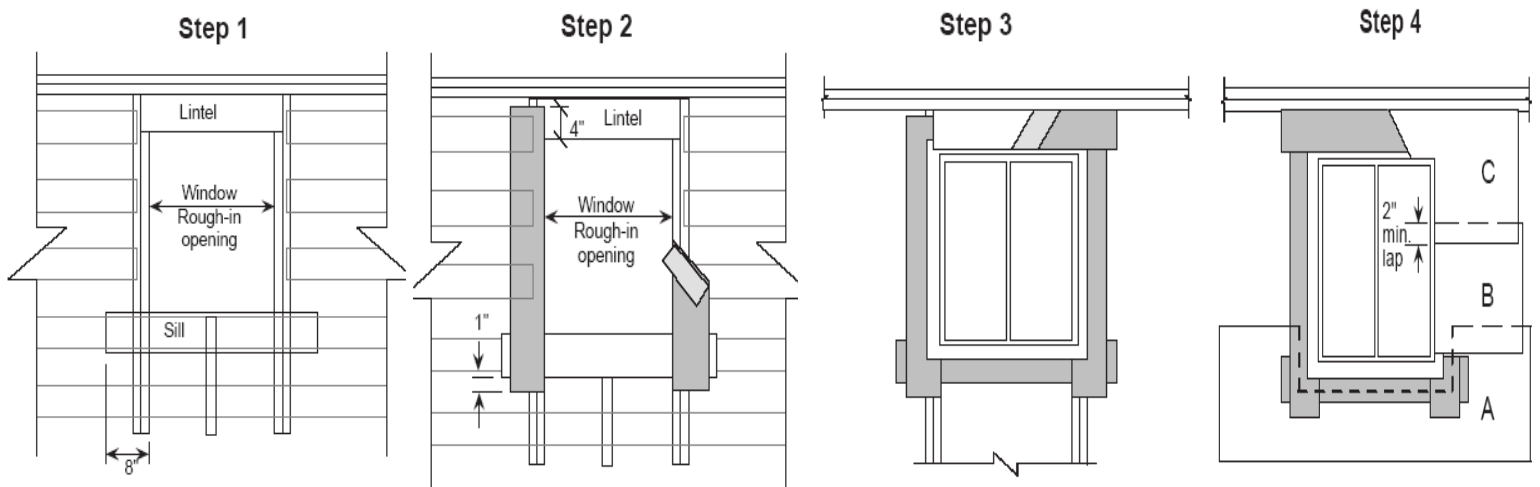

**Step 1:** Attach sill strip with top edge level with rough sill; extend beyond edge of rough opening at least 8”.

**Step 2:** Attach jamb strips with side edge even with rough- jamb framing. Start strip 1” below lower edge of sill strip and extend 4” above lower edge of lintel.

**Step 3:** Install window into rough opening with sill and jamb flange over previously installed flashing. Attach head flashing over the window flange.

**Step 4:** Commencing at the bottom (sole plate) of the wall lay building paper under sill strip, remove excess paper as shown by the dotted lines of paper “A”. Install successive lines of building paper over jamb and head flanges, lapping each course.

**NOTE:** This procedure covers only one of the most commonly used surface-mounted frame installations and can not be used for application to waterproof paper type siding. Refer to manufacture’s recommendations for other flashing methods.